

MANWAY DETAIL

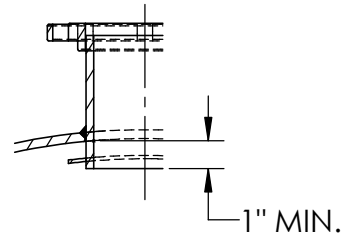

6" NOZZLE DETAIL

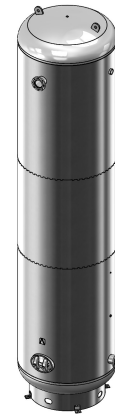

ITEM NO.	PART NO.	DESCRIPTION	QTY.
1	305995-SL1	SHELL LAYOUT FOR 72" TANK	1
2	305995-SL2	SHELL LAYOUT FOR 72" TANK	1
3	305995-SL3	SHELL LAYOUT FOR 72" TANK	1
4	H44840	.406 MIN. 72" O.D. 2:1 ELLIP. BEV. HEAD	2
5	F11920	3"-NPT 3000# FULL COUPLING	1
6	F10896	1"-NPT 3000# FULL COUPLING	2
7	F12470	1/4"-NPT 3000# FULL COUPLING	1
8	A99220	6NPS RFSO ASY.	2
9	F10140	1 1/4"-NPT 3000# HALF COUPLING	2
10	A72305	12" X 16" X 3/4" X 4" 300# MANWAY	1
11	A86004	STANDARD 1" X 6" X 6" LIFT LUG	4
12	A86003	BASERING ASSEMBLY	1
13	A20910	ASME DATA PLATE	1
14	A84390.72	6" PIPE BACKING RING	2

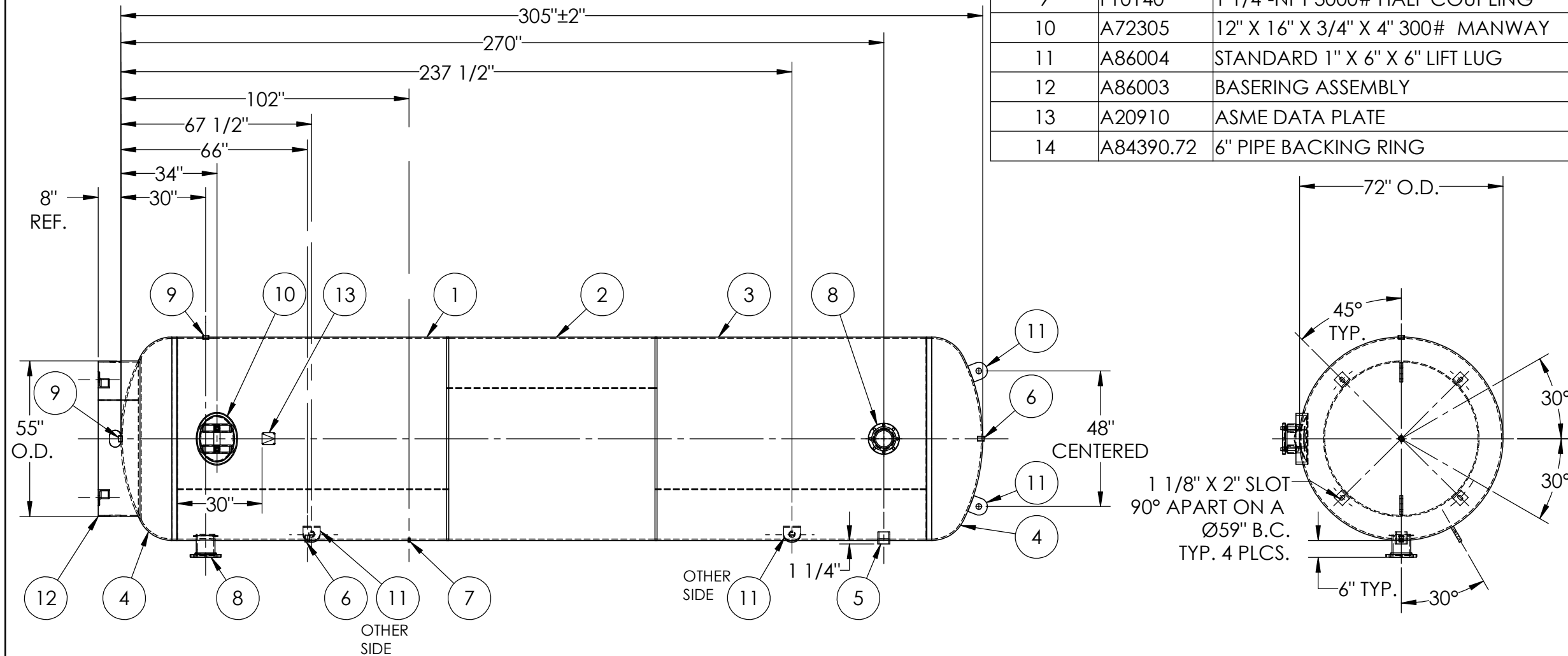

NOTES:

- BREAK ALL EXPOSED INTERIOR NOZZLE EDGES
- ALL FLANGE BOLT HOLES TO STRADDLE VESSEL CENTERLINES

SPECIFICATIONS

O.D. 72 LGTH. 305
WT. 11257 LBS.
S.A. 501 SQ.FT.
GAL. 5000 CU.FT.668.5 CRN: N/A
CODE: ASME Section VIII, Div.1, LATEST EDITION
STD. TOLERANCES: M-2461 (UNLESS OTHERWISE NOTED)

MAWP 200 PSI @ 400°F
W
EXMT UG-20(f) CORR ALW 0 SH 0 HD
WELD DETAILS: M-1932



VERTICAL AIR RECEIVER

RELEASED FOR PRODUCTION
Q.C. _____ DATE _____



REVISIONS				
REV.	BY	DESCRIPTION	DATE	APP.
A	EK			JC
B	HD			HD
C	UG			MK

DRAWN BY: JR	DATE:
APPR. BY: JR	DATE:
SCALE: NONE	DRWG NO. 305995