

ITEM NO.	PART NO.	DESCRIPTION	QTY.
1	A302496-SL1	SHELL LAYOUT FOR 54" O.D.	1
2	A302496-SL2	SHELL LAYOUT FOR 54" TANK	1
3	H44790	.284 MIN. 54" O.D. 2:1 ELLIP. JOG. HEAD	2
4	F10400	3"-NPT HALF COUPLING	1
5	F31826	1/4"-NPT FLAT FLANGE	1
6	F30263	1"-NPT RADIAL FLANGE	1
7	A99220	6NPS RFSO ASY.	2
8	A84390.54	6" PIPE BACKING RING	2
9	F10440	2"-NPT FLAT FLANGE	1
10	F31840	3/4"-NPT FLAT FLANGE	1
11	A95073	12" X 16" X 1" X 4" 300# MANWAY	1
12	A87973	4GA SADDLE ASSEMBLY	2
13	A84388	3/4" LIFT LUG STD HOR	2
14	A20910	ASME DATA PLATE	1

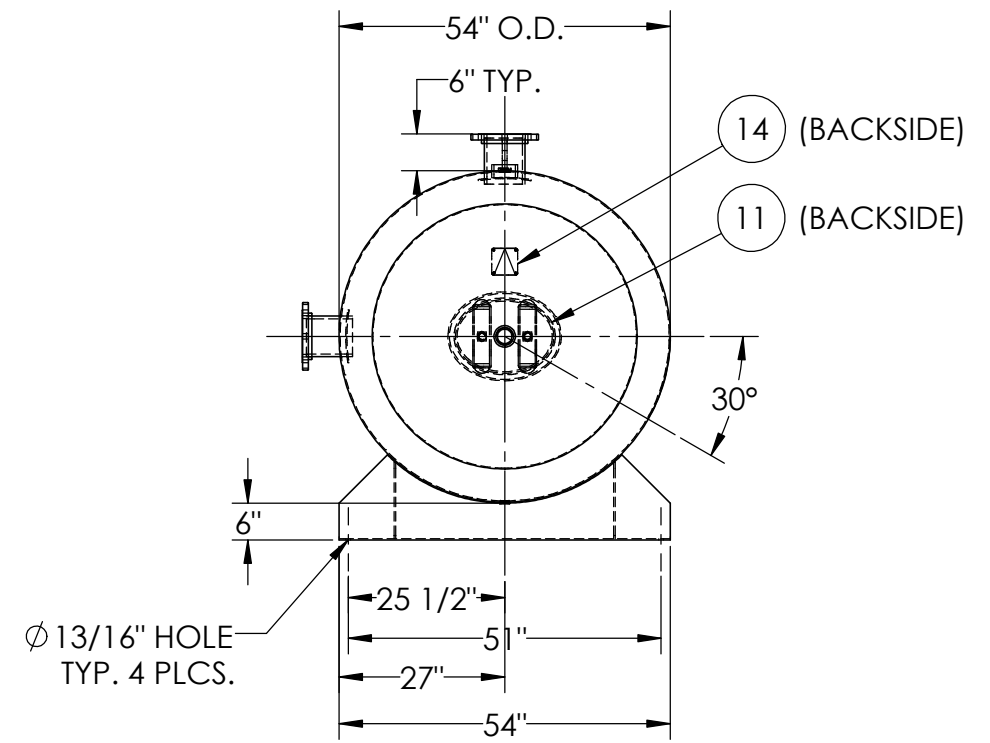

NOTES:
 1. BREAK ALL EXPOSED NOZZLE EDGES.
 2. ALL FLANGES BOLT HOLES TO STRADDLE VESSEL CENTERLINE.
 3. HEAD AND SHELL MINS ARW PER MANWAY AND RFSO CALCS.

SPECIFICATIONS	
O.D. 54 LGTH. 166	MAWP 165 PSI @ 400°F
WT. 3192 LBS.	
S.A. 207.9SQ.FT.	
GAL. 1550 CU.FT.204.38	CRN: AA0634.2C
CODE: ASME Section VIII, Div.1, LATEST EDITION	EXMT UG20(f) CORR ALW 0 SH 0 HD
STD. TOLERANCES: M-2461 (UNLESS OTHERWISE NOTED)	WELD DETAILS: M-1932



HORIZONTAL AIR RECEIVER

REV.	BY	DESCRIPTION	APP.
B	CDH		JR
C	JPR		JC
D	KAT		JC
E	RC		RC
F	DP		DP
G	LG		DS
H	RK		MK

RELEASED FOR PRODUCTION
 Q.C. _____ DATE _____

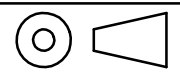

DRAWN BY:	BS	DATE:	
APPR. BY:	JR	DATE:	
SCALE:	NONE	DRWG NO.	302496